



CORPORATIVO POLANCO

Oficinas en renta
Jaime Balmes 8

1,082.50 m²
rentables

+ 243.78 m²
de Terraza privada

CBRE



Piso 1



**Superficie rentable
1,082.50 m²**



**Terraza perimetral
de 243.78 m²**



**Posibilidad de dividir
para dos inquilinos**



**Forma de entrega
obra gris**



**Asking price/m²
\$420 MXN**



**1 Cajón cada
30 m² rentables**



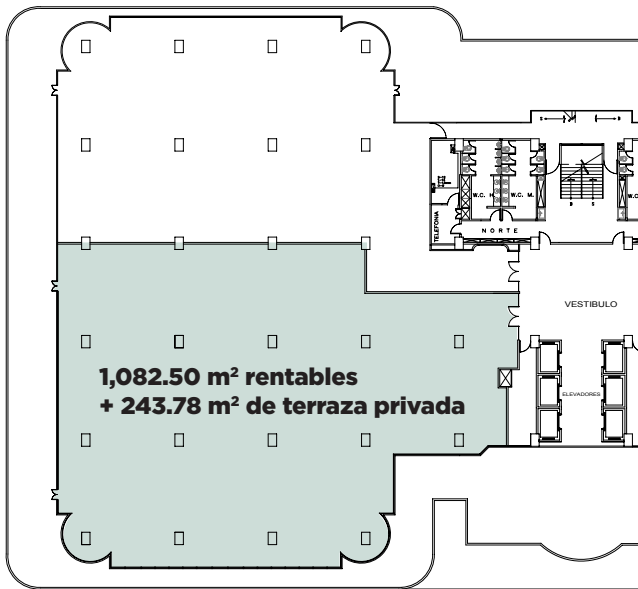

1 Inquilino

2 Inquilinos

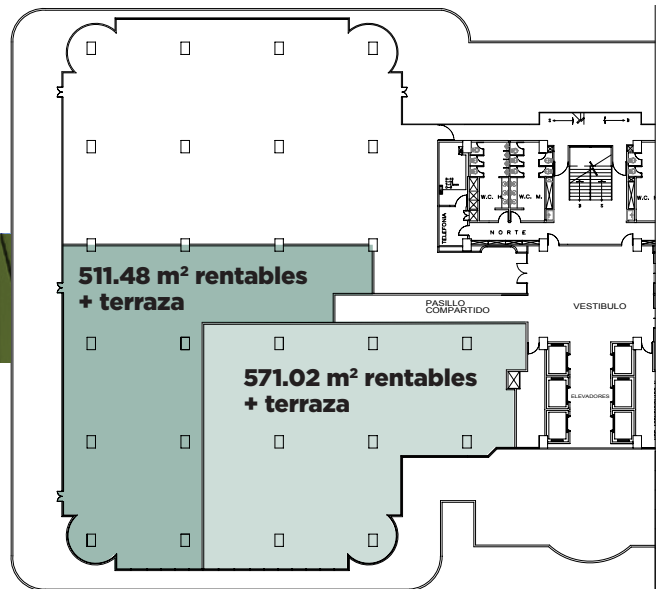



Contacto

Lorena García Cordero Sasía

T +52 55 4165 7455

lorena.garciacordero@cbre.com

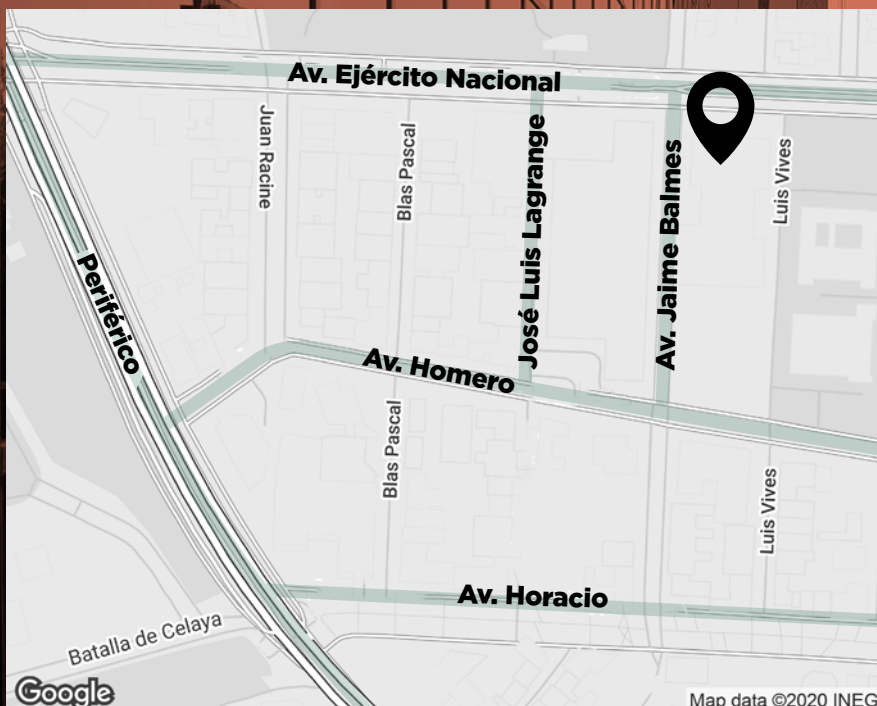
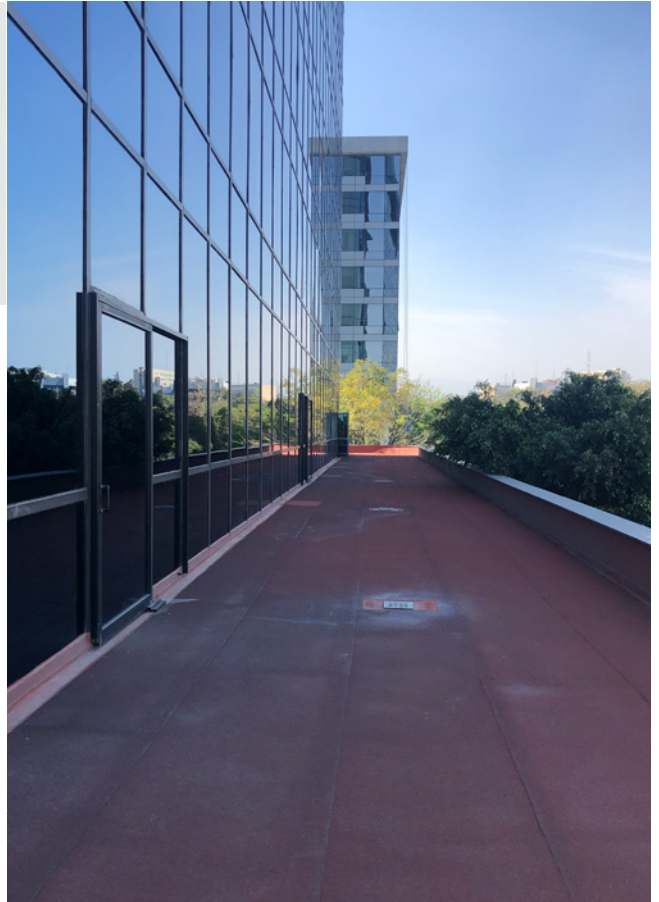

Excelente ubicación

**Av. Jaime Balmes 8,
Polanco, Miguel Hidalgo,
CDMX**

CBRE

© 2021 CBRE, Inc. All rights reserved. This information has been obtained from sources believed reliable, but has not been verified for accuracy or completeness. You should conduct a careful, independent investigation of the property and verify all information. Any reliance on this information is solely at your own risk.