

JAI ME

BALMES 8

OFICINAS EN RENTA

CBRE

JAIME BALMES 8

PISO 1



Superficie rentable
1,082.50 M²



Forma de entrega
ACONDICIONADO



Posibilidad de
DIVIDIR



Asking price / m²
\$480 MXN



TERRAZA PERIMETRAL
de 243.78 m²



1 CAJÓN CADA 30 M² rentables

1 INQUILINO

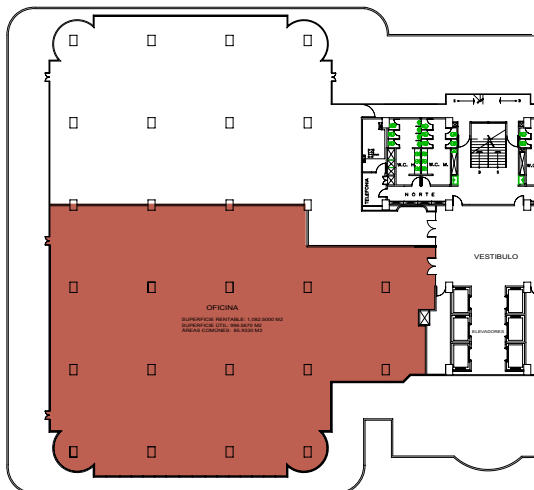

2 INQUILINOS

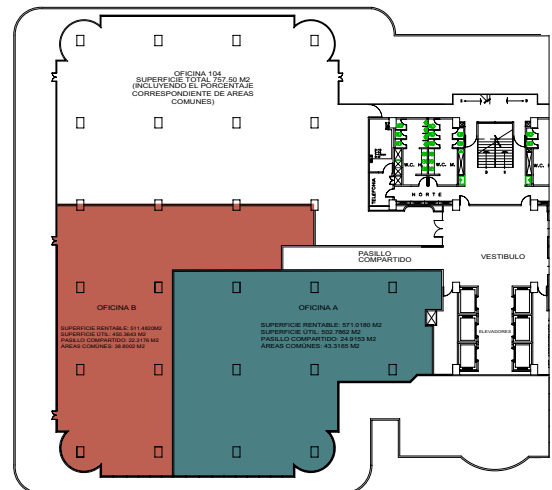



EXCELENTE UBICACIÓN



Av. Jaime Balmes 8, Polanco, Miguel Hidalgo, CDMX

CONTACTO

Lorena García Cordero Sasía

T +52 55 4165 7455

lorena.garciacordero@cbre.com



CBRE

© 2020 CBRE, Inc. All rights reserved. This information has been obtained from sources believed reliable, but has not been verified for accuracy or completeness. You should conduct a careful, independent investigation of the property and verify all information. Any reliance on this information is solely at your own risk. CBRE and the CBRE logo are service marks of CBRE, Inc. All other marks displayed on this document are the property of their respective owners, and the use of such logos does not imply any affiliation with or endorsement of CBRE. Photos herein are the property of their respective owners. Use of these images without the express written consent of the owner is prohibited.